

TP101 Installation Manual



Package Included:

Name	QTY	Name	QTY
Chassis	1	M4*50 hexagon screws	2
Motor	2	M3*8 hexagon screws	2
Track	2	M3*8 flat head screws	8
Bearing wheel	2	M4 nut	4
Driving wheel	2	gasket	4
18650 battery box	1	Top silk	2
Connector	2		

Installation Steps:

1. Install the bearing wheel (Install the M4*50 screws into the wheel),



Lock with M4 nut in another part



2. Put the gasket on the hole of the chassis, install the bearing wheel into the chassis.



To let the wheel move, there should be a little space between screw and wheel. Do not too tight. Import!

Install the gasket in another part, lock with M4 nut, **Pls note that Do not tighten too much the bearing wheel.**



3. Install the motor into the chassis, lock it with 3pcs M3*6mm flat haed screws.



4. Install the driving wheel: Firstly install the connector into the driving wheel, use the wrench to install the M3*8 hexagon screws into driving wheel to lock with the connector.



5. Install the driving wheel into the motor, lock it with top silk.



Note: The hole in the connector must be aligned with the flat end of the motor shaft, and the connector is stuck at the position of the arrow as the below picture showed.



5. Remove the track first and remove the excess parts



Measuring the required track length



Load the track pin into the track with the aid of a tool

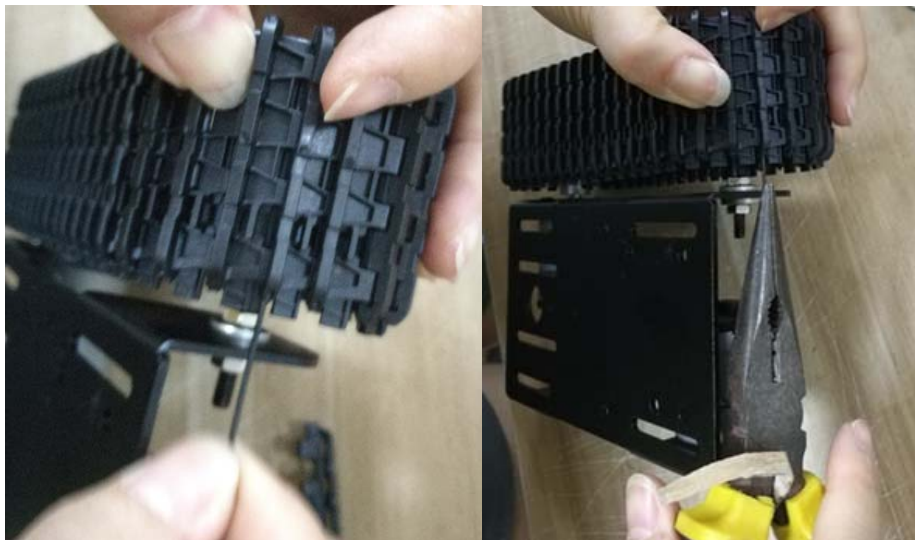

Finish, you can install the other half as the same way.



Support and service

Any problem, please contact us by the following.

Emails: yichond@doit.am; yichoneyi@163.com

Skype: yichone

Whatsapp: 008618676662425